

# Studio 18 Limited

Manufacturer and Supplier of Quality Body Jewellery

## How To Measure Jewellery

### Labret measurements:

"A" Would represent the "Thickness" or "Gauge" of the Labret in Millimeters (mm)

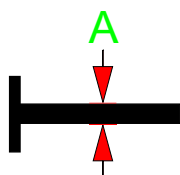

### Labret measurements:

"B" Would represent the: "Length" of the Labret in millimeters (mm)

"C" Would represent the: "Ball size" or "Ball Diameter" in millimeters (mm)

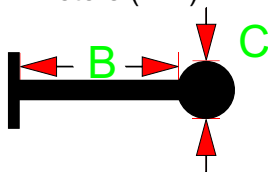

### Labret measurements:

"D" Would represent the: "Thread Size" of the labret in millimeters (mm)

"E" would represent the: "Thread size of the Ball" in millimeters (mm)

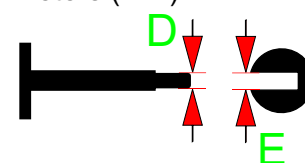

### Barbell measurements:

"A" Would represent the "Thickness" or "Gauge" of the Barbell in Millimeters (mm)

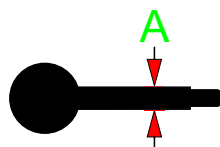

### Barbell measurements:

"B" Would represent the: "Length" of the Barbell in millimeters (mm)

"C" Would represent the: "Ball size" or "Ball Diameter" in millimeters (mm)

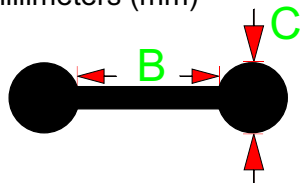

### Barbell measurements:

"D" Would represent the: "Thread Size" of the Barbell in millimeters (mm)

"E" would represent the: "Thread size of the Ball" in millimeters (mm)

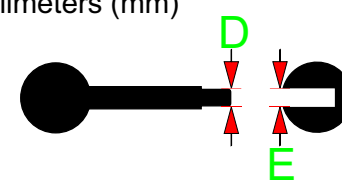

### Ball Closure Ring measurements:

"A" Would represent the "Thickness" or "Gauge" of the Ring in Millimeters (mm)

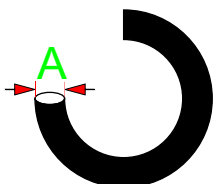

### Ball Closure Ring measurements:

"B" Would represent the inside "Diameter" of the Ring in millimeters (mm)

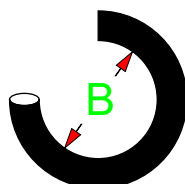

### Navel barbells (Belly bars) measurements:

"A" Would represent the "Bottom Ball size" "B" Would represent the "Bar length" "C" Would represent the "Top Ball Size" all in (mm)

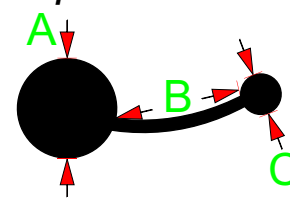

Tel: 0116 2862376 Fax: 0116 2862638  
info@studio18ltd.co.uk www.ukbodypiercingssupplies.co.uk  
28a Townsend Road, Enderby, Leicester, LE19 4PG

Prices exclude VAT and delivery. Studio 18 Ltd reserves the right to change prices without prior notice.  
Vat No: GB 786 751 771. Registered in England & Wales No:4372438.